



Toyota “T-Stage” Komenoki Condos

Client

Toyota Smile Life

Location

Komenoki, Nisshin, Japan

Use

20 & 14 Story Twin Residential
Condominiums Buildings with
4 Level Parking Structure

Facts

- Density - 135 DU/AC
- Number of Units - 168 DU
- Site Area - 1.24 AC
- Parking - 1 Parking Space/Unit

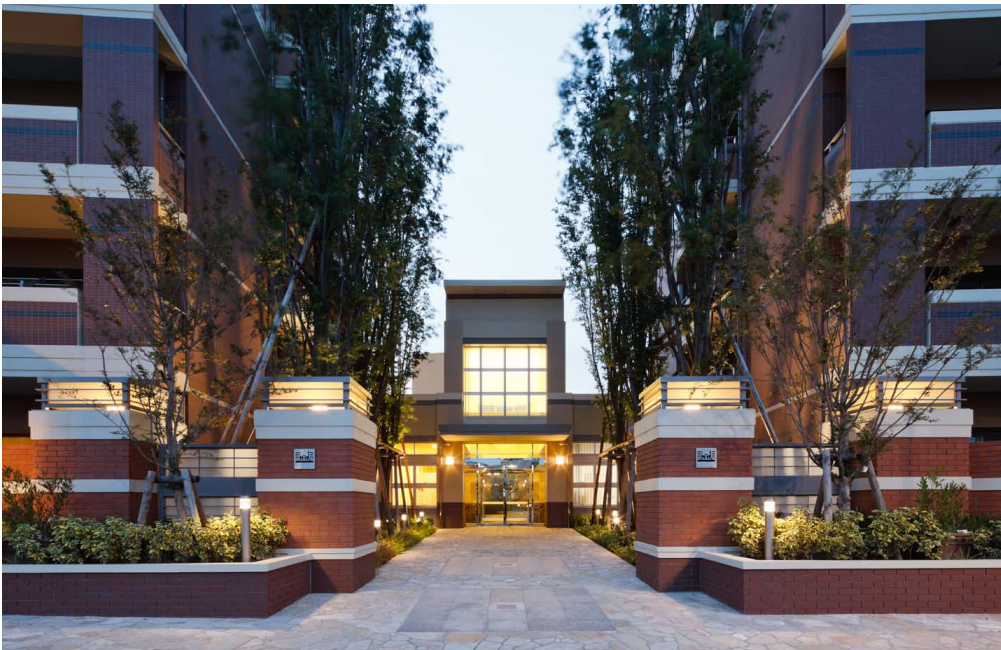

20070880 - Photography © Toyota Smile Life

The Komenoki high-rise residential complex features 168 stacked-flat condominiums and is conveniently located in front of a rail station and bus terminal. The transit-oriented, high-density residential community targets first-time home buyers, young families and professionals that work at nearby Toyota. Situated on 1.24 acres, the high-rise residential complex consists of two residential towers, a 20-story building and a 14-story building with a 4-level parking structure that serves the entire community offering one parking space per unit.



Architecture+Planning
888.456.ktgy ktgy.com

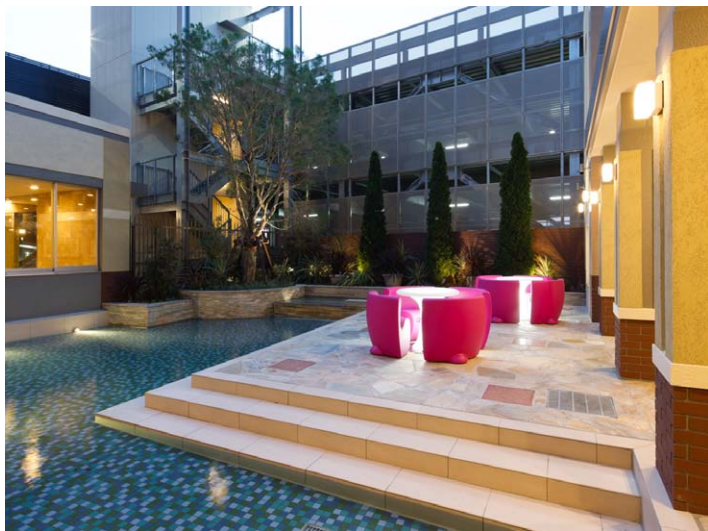

Toyota "T-Stage" Komenoki Condos



Architecture+Planning
888.456.ktgy ktgy.com