



20100379 - Photography © Henniker Photography

Vista La Verne Residence Hall

Client

Hanover Pacific, LLC

Location

University of La Verne
La Verne, CA

Use

Student Housing Above Bookstore

Facts

- Density - 236 Beds/AC
42.5 DU/AC
- Units Plan Sizes - 338-1,570 SF
- Total Building Plan - 101,087 SF
- Bookstore/Retail - 10,000 SF
- Number of Units - 68 DU
- Number of Beds - 378
- Site Area - 1.6 AC
- Parking Off Site - .75 Spaces/Bed
- LEED Gold Certified



Located on a former parking lot on the University of La Verne campus, the new student residence hall rises four stories above D Street and serves as a marquis entrance to the University along the southernmost entry into the city's Old Town La Verne district. At 101,087 SF, it is the largest construction project in the school's history and is LEED Gold certified. The new Campus Store, takes up nearly 10,000 SF of the building's ground floor and serves as a continuation of the retail street frontage found further down D Street. The remaining three-plus floors of space houses 378 students in a variety of multi-room suites as well as study areas, lounges, laundry rooms and more. The majority of the units are 4 bedroom units serving 6 students. All of the residences are arranged suite-style with private baths, appropriate furnishings and a shared living room featuring a flat-screen television with cable service. Each floor also includes community lounges, study rooms and multiple laundry rooms, all complete with appliances that accept debit card payment and that can send a text message when a load is finished. Internal to the site, there is a large resident courtyard that serves student activities and is the backdoor entrance for students coming from parking.



Architecture+Planning
888.456.ktgy ktgy.com



Resident Lobby



Club Room

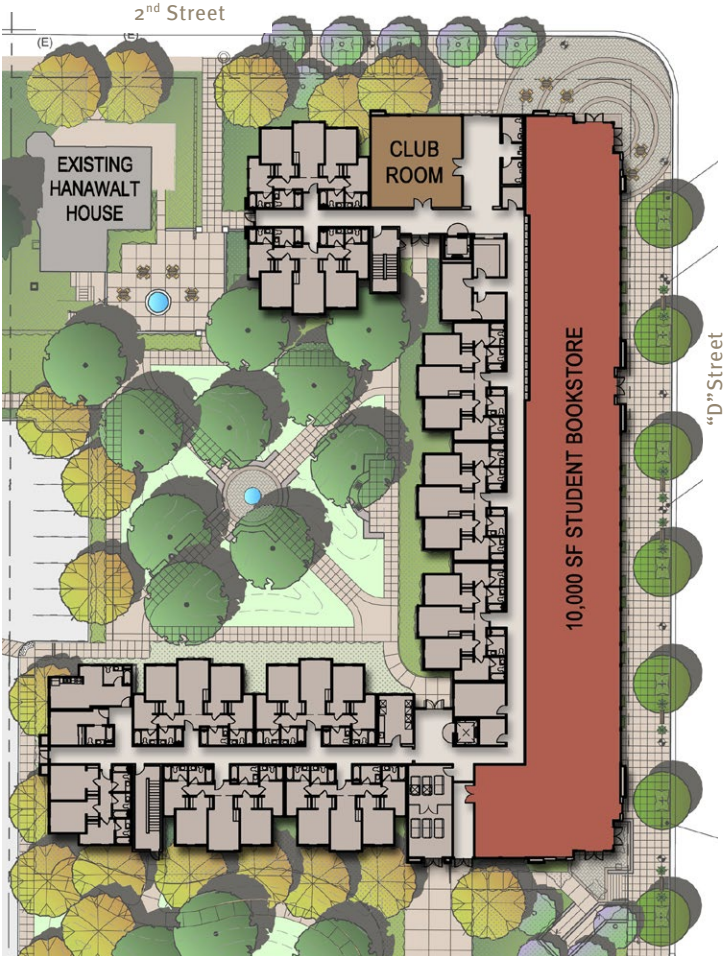

Building Plan



Bookstore



Floor Plan

Vista La Verne Residence Hall